

# Miha Čebulj

## UNDERSTANDING RESPONSIVE ARCHITECTURAL ENVELOPE

*Towards design of  
responsive elements as  
integral parts of architecture*

### AUTHOR

PhD candidate, Faculty of  
Architecture, University of  
Ljubljana, [www.mc-a.si](http://www.mc-a.si)  
[miha.cebuj1@gmail.com](mailto:miha.cebuj1@gmail.com)

### SUPERVISORS

Matej Blenkuš (Faculty of  
Architecture, UL,  
[matej.blenkus@fa.uni-lj.si](mailto:matej.blenkus@fa.uni-lj.si)),  
Tadeja Zupančič (Faculty of  
Architecture, UL,  
[tadeja.zupancic@fa.uni-lj.si](mailto:tadeja.zupancic@fa.uni-lj.si))

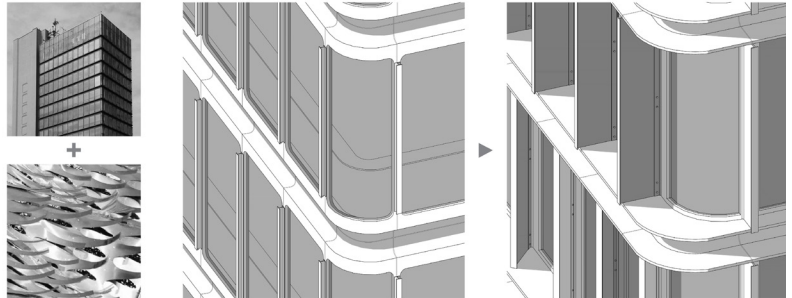

Article outlines the definition of responsiveness in architecture in an attempt to enable architects to think about the major aspects of responsiveness and explore its potential in architectural applications, which focus on cultural relevance, beyond fascination with electronics and mechanical systems. This paper aims to present a comprehensive and structured framework of classification of examples of responsive architecture, to be able to place the variety of concepts in context with each other. Based on this, and tacit knowledge of the author, from the architectural design practice, the specific design method is proposed and tested through several student experimental projects at elective subject Detail in architectural composition course at Faculty of Architecture in Ljubljana. The goal was to propose responsive building envelopes which would yield qualitatively beneficial

effects and cultural impact on the society through redesigning the facades of selected iconic modernistic buildings in Ljubljana. Results of the projects were evaluated through focus group discussion (with students involved in the projects) on the topic of design methods and tools, technology and cultural impact of responsiveness in architecture.